

# DAWSONS

Property Professionals since 1925

18/20 STAMFORD STREET STALYBRIDGE CHESHIRE TEL: 0161 338 2292

Website: [www.wcdawson.com](http://www.wcdawson.com) Email: [reception@wcdawson.com](mailto:reception@wcdawson.com)



## Newmarket Road, Ashton-Under-Lyne, OL7 9LU

Dawsons are pleased to offer for sale this well proportioned, two bedroom mid terrace is situated in a popular and established residential area with good access to local amenities. An internal inspection is highly recommended. No forward vendor chain.

Local amenities are available in the Waterloo area of Ashton under Lyne whilst a wider range of amenities are available in the town centre which is readily accessible. The town centre's bus, train and Metrolink stations provide excellent commuter links.. Also within easy reach are several well regarded junior and high schools.

**Price £175,000**



**CHARTERED SURVEYORS, ESTATE AGENTS  
& PROPERTY MANAGEMENT SPECIALISTS**



# Newmarket Road, Ashton-Under-Lyne, OL7 9LU

- Traditional Mid Terraced
- Well Placed for Daisy Nook and Park Bridge
- 2 Well Proportioned Bedrooms
- Good Commuter Links
- Popular Convenient Location
- No Forward Vendor Chain

The Accommodation briefly comprises: **Kitchen/Dining Room**

Lounge with feature fireplace, Dining Kitchen with integrated appliances

To the first floor there are two well proportioned Bedrooms, Bathroom/WC with white suite

Externally the property sits behind a forecourt garden whilst to the rear there is a larger than average enclosed yard area which is not directly overlooked

## Ground Floor

### Lounge

14'2" x 13'3" (4.32m x 4.04m)

Composite style security door, feature fireplace, uPVC double glazed window, central heating radiator.

### Inner Hallway

Built-in understairs storage cupboard, stairs to first floor.

13'1" x 9'10" (4.01m x 3.02m)

(plus uPVC double glazed box bay window). Inset single drainer stainless steel sink unit, range of re-fitted wall and floor mounted units, integrated stainless steel oven, four ring gas hob with extractor unit over, plumbed for automatic washing machine, part tiled, recessed spotlights, central heating radiator, composite style security door onto rear Yard.

## First Floor

### Landing

### Bedroom (1)

14'4" x 13'3" (4.37m x 4.04m)

Bulkhead storage cupboard, uPVC double glazed window, central heating radiator.

### Bedroom (2)

10'0" x 8'7" (3.07m x 2.62m)

uPVC double glazed window, central heating radiator.

## Bathroom

Double glazed window, re-fitted three piece bathroom suite comprising panelled bath with shower over, pedestal wash hand basin and low level WC, pvc boarded walls, tiled floor, recessed spotlights, central heating radiator.

## Externally

Forecourt Garden. Large enclosed paved rear yard.

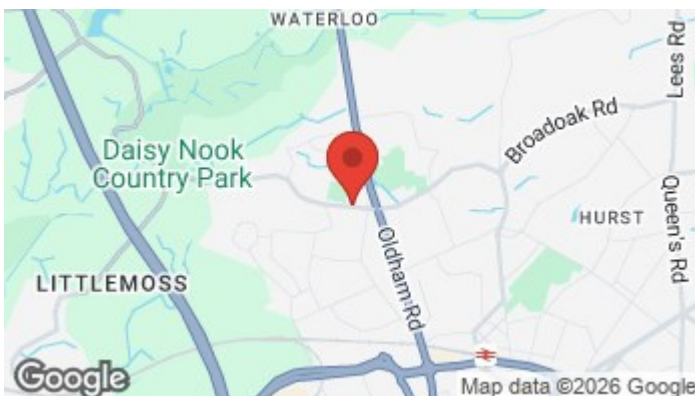

## Directions



# Floor Plan

GROUND FLOOR

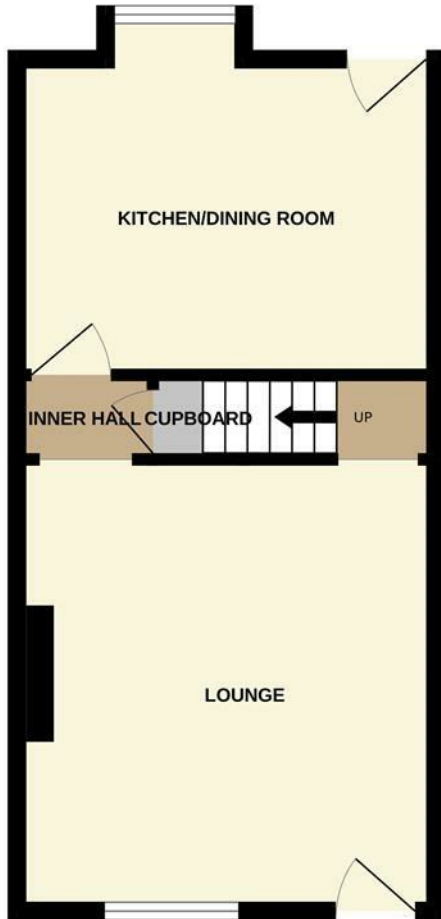

1ST FLOOR

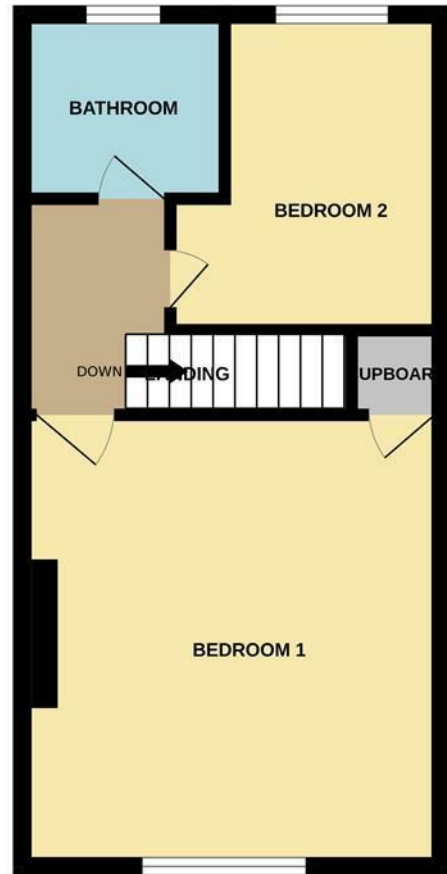

Whilst every attempt has been made to ensure the accuracy of the floorplan contained here, measurements of doors, windows, rooms and any other items are approximate and no responsibility is taken for any error, omission or mis-statement. This plan is for illustrative purposes only and should be used as such by any prospective purchaser. The services, systems and appliances shown have not been tested and no guarantee as to their operability or efficiency can be given.  
Made with Metropix ©2026

These particulars, whilst believed to be accurate are set out as a general outline only for guidance and do not constitute any part of an offer or contract. Intending purchasers should not rely on them as statements of representation of fact, but must satisfy themselves by inspection or otherwise as to their accuracy. No person in this firm's employment has the authority to make or give any representation or warranty in respect of the property.

